

Floor plans

Ground Floor

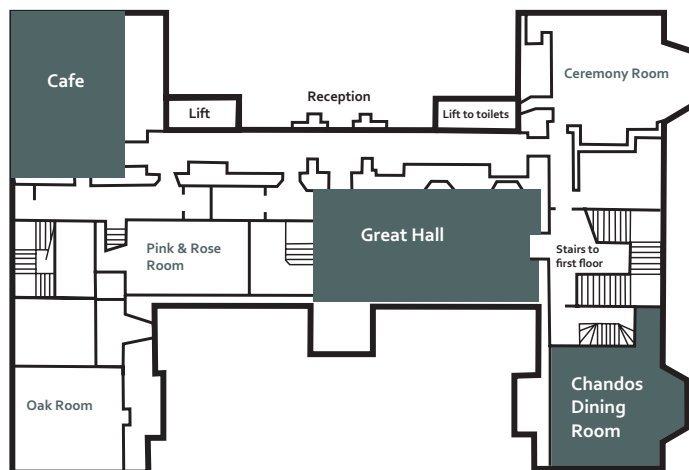

First Floor

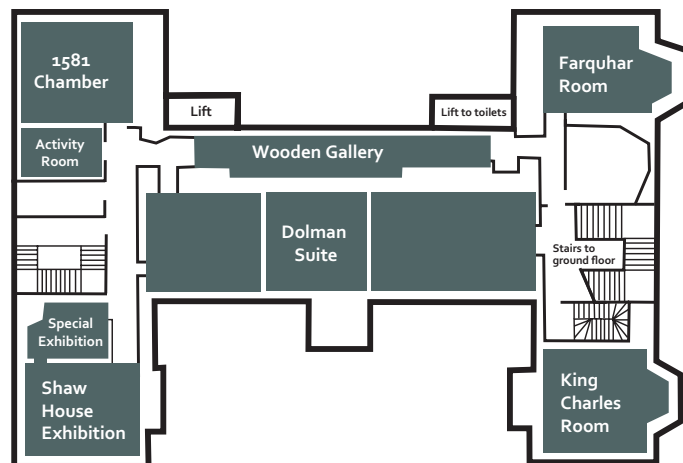

Toilets are located in the basement and can be accessed via the east lift (as indicated on the floor plan). Baby changing facilities are located in the mens and womens accessible toilets in the basement.

Please note: there is no access to the 2nd floor which is used for private offices. Some rooms shown on the floor plans may be closed if being used for a private event.

Public Opening

The House and Grounds are open every weekend and school holiday from mid-February to late September. During this time, there may be some dates on which the House is closed due to private events. For confirmation of our opening dates and times, it is advisable to check the website ahead of your visit. www.westberkshireheritage.org/shaw-house/plan-your-visit

Entry is free, however donations are most welcome as they help us maintain our beautiful Elizabethan mansion for future generations to enjoy.

Events & Activities

Shaw House hosts a year round programme of events including a Spring, Summer and Christmas Fair, outdoor theatre, cinema, family activity days and craft workshops. For more information please visit www.westberkshireheritage.org/whats-on

Accessibility

Most areas of Shaw House are accessible to those with limited mobility, with lifts to the first floor and basement. We also have dedicated parking and toilet facilities for people with disabilities.

Visitors will be asked to leave push chairs on the ground floor. Hip seats (suitable for children from 6 months to 3 years) are available from reception.

Only assistance dogs are permitted inside the House. Large print copies of the room interpretation boards are available from reception.

Contact Us

E: shawhouse@westberks.gov.uk
T: 01635 279279



www.westberkshireheritage.org



Welcome to Shaw House

www.westberkshireheritage.org

Discover

The Hall

Originally this room would have been twice the height, with light flooding in from both the north and south sides. Traditionally the first point of entry for visitors, its size would have emphasised the status of the House.

Chandos Dining Room

Used by the Duke as his Dining Room in the 1730s, the plaster work would have originally been gilded in gold. The reproduction Chinese wallpaper is a close match for the decorative scheme from the 18th Century.

King Charles Room

It is said that a musket ball was fired through the window of this room, narrowly missing King Charles I at the beginning of the Second Battle of Newbury. A plaque can be seen on the wall which shows damage to the panelling.

The Dolman Suite

This suite was created as a State Apartment for Queen Anne who visited in 1703. In later years Dolman 1 was used as a ballroom, with sound proofing sand found in the floorboards during restoration.

The Wooden Gallery

This was built in 1850 to improve access and allow servants to get to other areas in the House without walking through the main rooms. The panelling was originally situated on the Second Floor and features graffiti dating to 1744.



Explore

Exhibition Rooms

Here you can learn about the dynamic history of the House, from its beginnings as the family home to the Dolmans in 1581, through to its transformation and restoration in the early 21st Century. We also have a changing programme of Special Exhibitions curated by West Berkshire Museum, please visit the website for information on the current exhibition on display.

Reveals

In many of the rooms you can explore the hinged 'reveals'. During restoration, many hidden secrets were discovered behind the panelling including Elizabethan fireplaces and windows, as well as superstitious witch marks and forgotten doorways. The hinged panelling now allows these secrets to be revealed to you!

Activity Room

Our Family Activity Room on the First Floor has plenty of activities for your little ones and we have free activity trails, for both inside the House and in the Gardens, which are available from Reception.

Gardens

Visitors can explore the Orangery and Great Lawns within 15 hectares of Grade II listed grounds. You are welcome to bring a picnic and enjoy our garden games. Dogs on leads are very welcome in the grounds.

In the Kitchen Garden you will find a grass amphitheatre, a bug hotel and raised beds which are tended to by local community groups.



Enjoy

Gift Shop

Our shop stocks a variety of Shaw House gifts, as well as locally-produced homeware, jewellery and ceramics. Clothing, accessories, toys and cards are also available to purchase – plenty to buy as gifts for someone special or a treat for yourself!

You can also peruse the gift shop from the comfort of your home as many items are available to buy online www.westberkshireheritage.org/shop

Guide Book

A guide book is available to purchase from the gift shop. Exploring the rich history of Shaw House with stories of its many industrious and flamboyant owners, royal visitors, connections to the Second Battle of Newbury in 1644, its requisition during World War Two and how it became Shaw House School.

Café

The café is located in what used to be the kitchen, the old fireplace and smoke jack can still be seen! Choose from a range of delicious sandwiches and homemade cakes. Also on offer are a variety of barista style coffees and Fairtrade, organic teas and New Forest ice cream.

Visitors are welcome to picnic in the grounds. Picnic hampers are available to purchase from the café on select days during the summer which include locally made sandwiches, light snacks, drinks and a waterproof blanket for you to borrow during your visit.

